

SWS

**Deck2wall[®] Spacers
HELPS PREVENT ROT
PROVIDES DRAINAGE
AND AIRFLOW**

For deck ledger installations,
use Deck2wall[®] SWS with the
following approved fasteners:

- FastenMaster[®] LedgerLOK[®]**
Length - 5"
- Simpson Strong-Tie[®]**
SDWS22500DB - 5"
- SPAX[®] PowerLags[®] w/HCR[®]**
5/16" or 3/8" T-Star or Hex
Washer Head - 5" Length.

Fasteners shall be installed in
accordance with the fastener
manufacturer's instructions,
including on center spacing,
end and edge distances. All
instructions are available at:
deck2wallspacer.com/sws

ATTACHMENT SCREWS

Spacers shall be attached to the
ledger with 3 screws, #8 x 1 5/8"
minimum, approved for treated
lumber and suitable for
environmental conditions. SPAX[®]
PowerLags[®] require SPAX[®] screws
per their instructions.

**Verify local codes prior to
installation.*

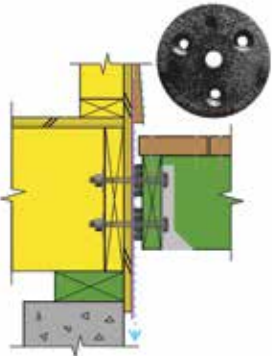

Deck2wall, Inc.
Rohnert Park, CA
Toll Free 888 577-2237
www.deck2wallspacer.com

INSTALLATION GUIDE - MODEL D2W38-SWS

1. Cut Ledger to length and lay out joists.
2. Lay out fasteners in accordance with fastener manufacturer's instructions / tables.
3. Drive structural wood screws into ledger until they penetrate about 1/4" through the back of the ledger.
4. Place spacers over protruding tips of structural screws and fasten to ledger with 3 - #8 x 1 5/8" screws unless otherwise noted.
5. Other sealant to spacers.
6. Carefully position ledger in the desired location and drive structural wood screws into structure.

SUPPORTING DOCUMENTATION

FastenMaster[®] LedgerLOK[®] provided by FastenMaster[®].

Simpson Strong-Tie[®] provided by Deck2wall, Inc. WSU Test Report & Simpson Strong-Tie[®]

SPAX[®] PowerLags[®] provided by SPAX[®]

SPECIAL INSTRUCTIONS

for using Simpson Strong-Drive[®] SDWS TIMBER screws - Deck Ledger-to-Rim Board table. To compensate for spacer thickness, use 5" SDWS screws instead of 4" SDWS screws for single 2x ledger connections. Spacers are not permitted on 2-2x or double ledger configurations.

Trademark Attributes: FastenMaster[®], LedgerLOK[®], Simpson Strong-Tie[®], SPAX[®] and PowerLags[®] are registered trademarks of their respective companies.

OTHER USES:

**SHADE STRUCTURES,
POSTS, STAIR STRINGERS,
LANDINGS...**

ICC-IAS Accredited Lab Tested

EFFECTIVE JULY 1, 2022

Check our website or contact Deck2wall, Inc. to ensure this is the most recent version of our instructions.

2.



3.



4.



5a.

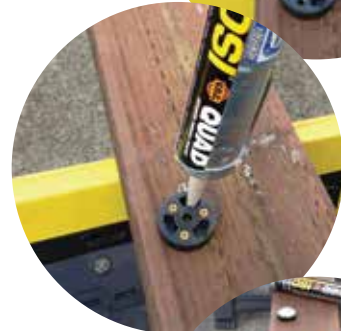

5b.

