

6 INSTALLATION

- 6.1 Installation shall comply with the manufacturer's installation instructions and this TER. In the event of a conflict between the manufacturer's installation instructions and this TER, the more restrictive shall govern.
- 6.2 The $\frac{5}{16}$ " PowerLag® structural wood fastener must be installed with a $\frac{1}{2}$ " (12.7 mm), low rpm/high torque electric drill (450 rpm) or impact wrench using the appropriate driver bit. Drive the fasteners through the ledger and sheathing into the band joist until the built-in washer head is drawn firm and flush to the ledger board. Do not overdrive.
- 6.3 Install PowerLag® fasteners such that the threads fully engage the band joist material and the fastener tip extends beyond the back face of the band joist material when fully seated against the installed ledger.

 - 6.3.1 A third party tested plastic washer (e.g., Deck2Wall® Spacer) may be installed between the ledger board and band joist at each fastener location. The plastic washer shall be installed per the washer manufacturer's instructions and this TER.
 - 6.3.1.1 The third party tested plastic washer shall be 2" in diameter, $\frac{1}{2}$ " thick (max), with an approximate $\frac{5}{16}$ " hole in the center for the PowerLag® and three $\frac{3}{16}$ " (approx.) holes for the #8 screws.
 - 6.3.1.1.1 The third party tested plastic washer shall be independently fastened to the ledger with three SPAX® #8x1- $\frac{5}{8}$ " or three SPAX® #8x2" screws.

- 6.4 Lead holes are not required.
- 6.5 Figure 3 shows a detail of the PowerLag® fastener deck connection, including minimum edge and end distances.
- 6.6 Stagger the PowerLag® fasteners from the top to the bottom along the length of the ledger while maintaining the required edge and end distances.

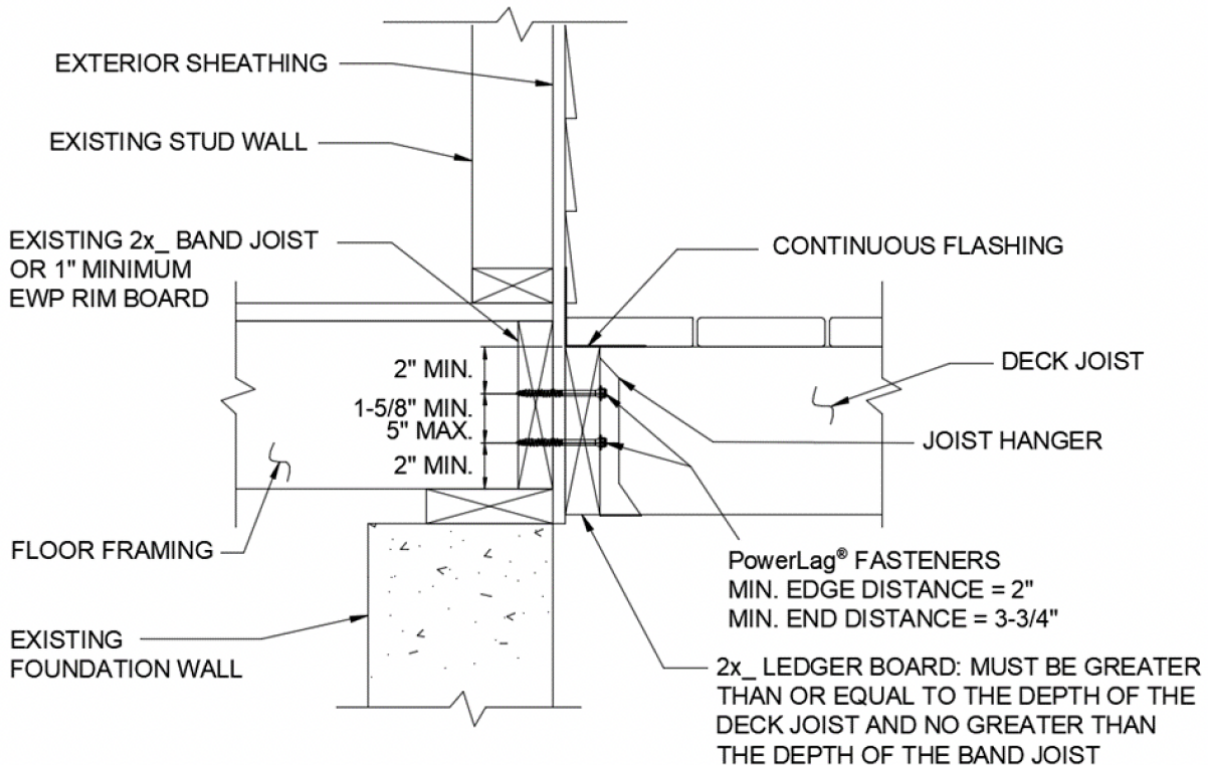

FIGURE 3. POWERLAG® FASTENER DECK CONNECTION

- 6.7 For applications outside the scope of this TER, an engineered design is required.